



UNILUX

---

AMBIANCE 2.0

# AMBIANCE 2.0

---



**AMBIANCE 2.0** is a floor lamp with fabric lampshade. It diffuses a nice light to brighten up reception halls or offices.

# AMBIANCE 2.0



- **Ideal for welcoming reception areas** : add a touch of colour while creating a cozy lighting ambiance.
- **USB port included** : USB 2.0 type A connection integrated 5 V, max. 1 A. Recharge your smartphone or tablet (cable not included).
- **Sober design** : timeless design thanks to its slim pole, stable rounded foot and conical shape lampshade.
- **Soft light** : high quality heat resistant fabric. The lampshade is easy to clean and release a soft light for an eye-soothing effect.
- **Energy efficient** : bundled with an 11W E27 bulb, cost-saving energy LED.
- **Available in 5 colors** : blue, white, red, orange and green. Add a touch of colour!
- **ON/OFF switch** : easy access thanks to the cord.

Warranty: 2 years

Height: 65 cm

Materials: arm and metal base with epoxy painting finishing / fabric lampshade



End user replaceable light source (LED only)

## Characteristics

Lux measurement on the work surface in top view at 35 cm:

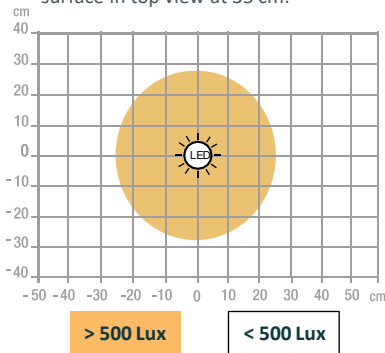

Measurement in Lux on the worktop in profile view at 35 cm:

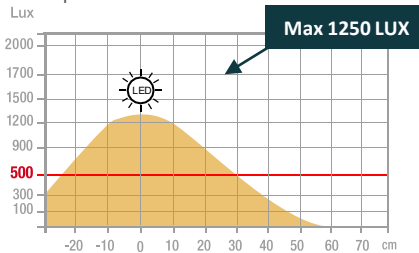

Measurement in nanometers of the light spectrum

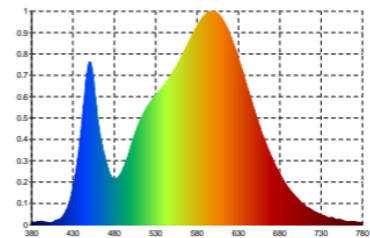

- 0 No-risk
- 1 Low-risk
- 2 Moderate-risk
- 3 High-risk

SAP no.	400166612	400166607	400166610	400166611	400166609
EAN code	3595560036783	3595560036707	3595560036745	3595560036769	3595560036721
Colors	White	Blue	Orange	Red	Green
Luminous flow	915	915	915	915	915
Lux at 35cm	1250	1250	1250	1250	1250
Lm/W	83	83	83	83	83
Color T° ( K)	3000	3000	3000	3000	3000
CRI	84	84	84	84	84
Source Lifetime (h)	30 000	30 000	30 000	30 000	30 000
Energy consumption (kWh/1000 h)	11	11	11	11	11
USB Port	Yes	Yes	Yes	Yes	Yes
Inductive charger	No	No	No	No	No
Net weight (kg)	1,55	1,55	1,55	1,55	1,55

# OUR CSR COMMITMENTS

1. All our lighting are **100% repairable** thus limiting planned obsolescence.
2. Reduce our carbon footprint through our **ECO-DESIGN THINKING** approach.
3. Contribute to the preservation of the planet's natural resources by promoting the use of **recycled materials**.
4. Optimize our packaging to control our **transport costs**.
5. Highlight the **talent of our employees** by ensuring social equality.

## Energy class

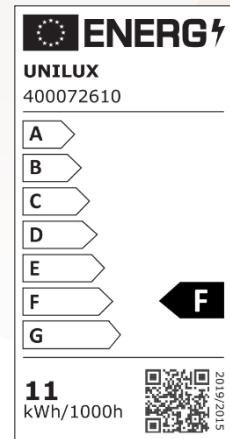

# OUR EXPERTISE

## 1-Why use auxiliary lighting?

We are regularly subjected to constant artificial lighting in the office, which takes no account of our biological rhythms. Poor lighting quality can cause headaches, sleep disorders and loss of concentration. According to a recent study, only 34% of offices achieve the level of illumination of 500 lux recommended by Occupational Medicine in accordance with DIN EN 12464-1\*.

## 2-How to light your workspace?

- Position the lamp head at least 35 cm above the worktop. work surface.
- Place the lamp on the opposite side to the hand that is holding the mouse or writing.
- Use lamps with asymmetrical lighting to reduce eyestrain, which can lead to eye irritation, headaches, loss of concentration, reduced productivity, etc.
- Position the lamp so that it is easy to adjust and so that the light is in the right place.
- Avoid reflections from shiny surfaces.
- Limit direct glare from bright light in the field of vision and indirect glare from bright light in the field of vision. in the field of vision and indirect glare from the reflection of light from the reflection of light in the field of vision, on a work surface walls or objects.

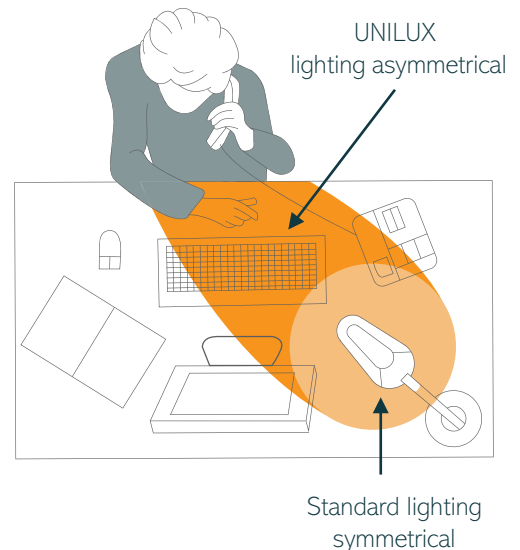

# OUR CERTIFICATIONS

Unilux is committed to an eco-responsible approach and ensures that its products respect this commitment. Indeed, we are very concerned about current environmental issues and we aspire to respond as best as possible to the concerns of our consumers on this subject. Sustainable development is at the heart of our strategy and we act for the environment. You will find below the different certifications that Unilux has and that prove its environmental commitment.



La marque de la gestion forestière responsable

# UNILUX

\* DIN EN 12464-1 (DIN 5035-1): European standard which determines the lighting requirements for workstations in closed places, these satisfying the needs of comfort and visual performance. DIN EN 12464-1 replaced DIN 5035-1

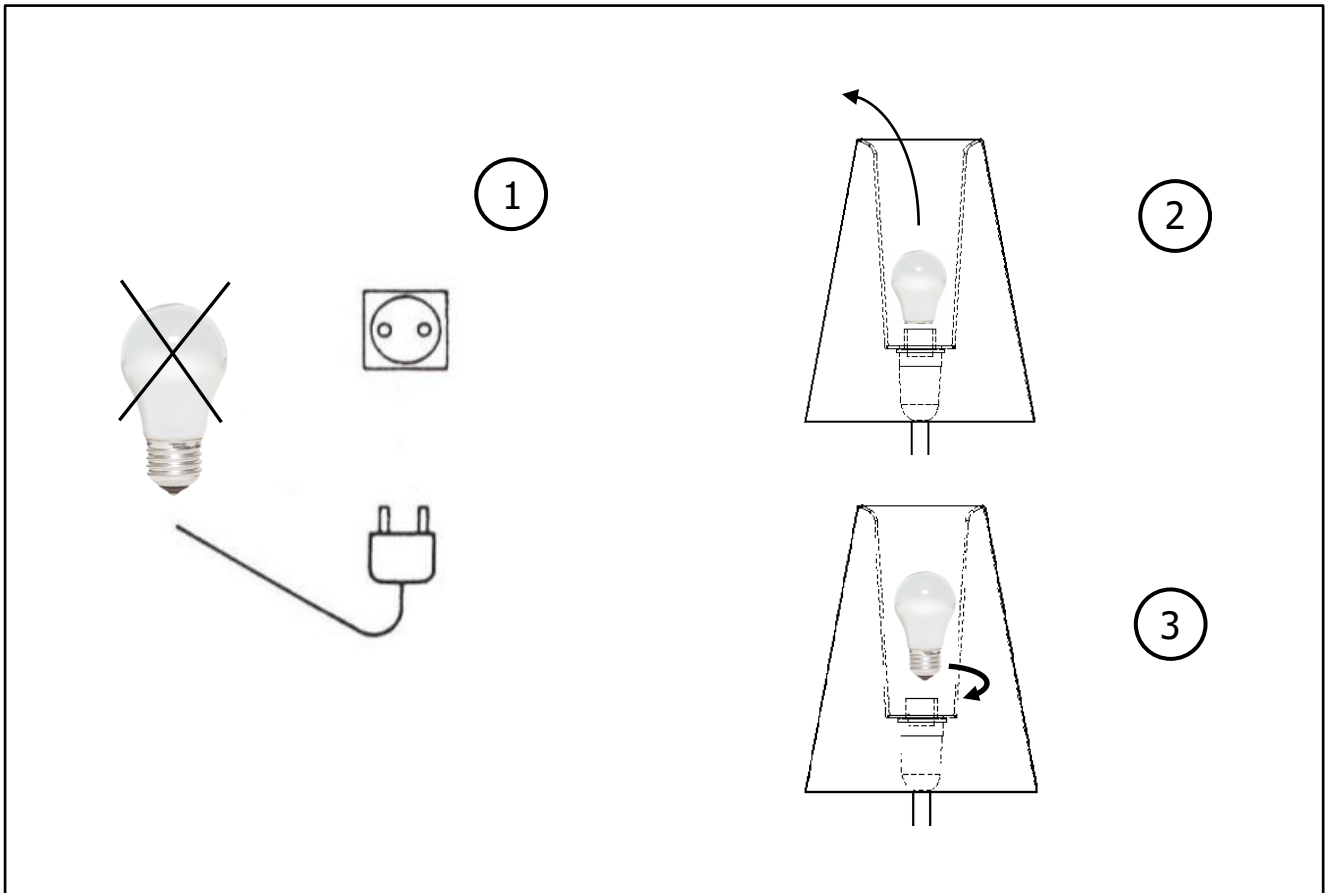
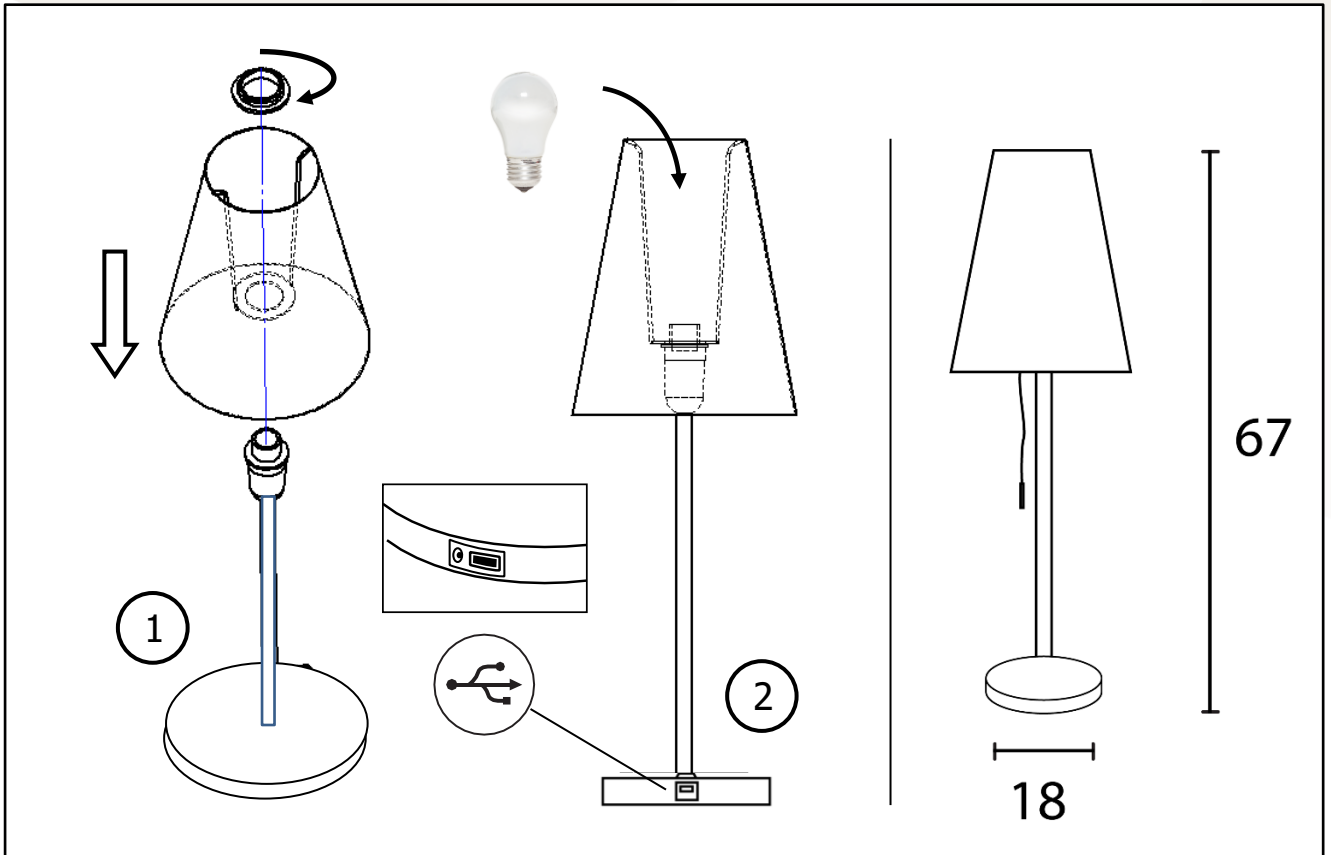

## 30 products available on pCon Planner

You will be able to obtain data on many UNILUX or OFML standard products and integrate them quickly and easily into 3D space layouts via pCon.



## Download on our E-shop

Always available: photos in HD, data sheets, instruction manual, repairability instructions for all our products.



## Do you have any questions?

Our after-sales service is always at your disposal

Tèl: +33 1 81 86 06 03

E-mail: [contact.unilux@hamelinbrands.com](mailto:contact.unilux@hamelinbrands.com)

17 avenue du Parc TECHNOPOLES

91380 Chilly Mazarin – France

Tèl: +33 1 81 86 06 00

[www.my-unilyx.com](http://www.my-unilyx.com)

E-mail: [contact.unilux@hamelinbrands.com](mailto:contact.unilux@hamelinbrands.com)

UNILUX